

# WHITELAW RIGGING & FAB.

## Alloy Steel J-Hooks

### Alloy J-Hooks and Alloy S-Hooks

- All hooks are fabricated from alloy steel, heat treated, proof tested, stamped with Working Load Limit, and batch serial number.
- Other configurations can be designed and fabricated.
- Maximum use temperature is 400° F.
- Inspect before each use. Discard if deformed, nicked, worn or heat damaged.
- Do not side load or tip load.
- See Care and Use Instructions.

### Eye Styles



### Options

“JW” Wide Bowl

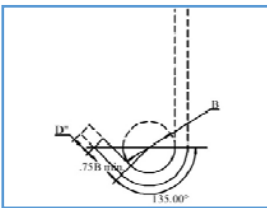

Open bowl. Tip angle typically at 45° to vertical. Load at base of bowl only.

“JL” L-Style Bowl

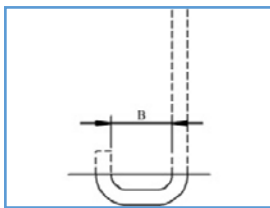

Load assumed to be closest to tip. Significant reduction in WLL.

“LE” Large Eye

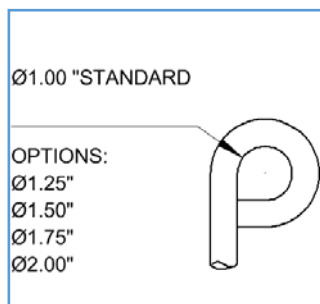

### Alloy S-Hooks

Custom designs and paintline hooks are also available. Contact us for all special applications.

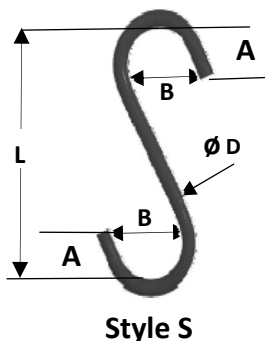

Style S

### Common Alloy J-Hooks ± 5% on Dimensions

ID Number	Working Load Limit (Lbs.)	Rod Dia. D	Length L	Inside Eye Dia. E	Bowl Width B	Bowl Depth A
J1/4X8X21/2C	40	1/4"	8"	1.00"	2.50"	1.50"
J5/16X8X13/4C	200	5/16"	8"	1.00"	1.75"	1.50"
J5/16X41/2X1C	220	5/16"	4-1/2"	1.00"	1.00"	1.125"
J5/16X5X11/4C	250	5/16"	5"	1.00"	1.25"	.94"
J3/8X4X11/2C	350	3/8"	4"	1.00"	1.50"	1.625"
J3/8X6X13/4C	300	3/8"	6"	2.00"	1.75"	1.375"
J1/2X6X1C	800	1/2"	6"	1.00"	1.00"	1.00"
J1/2X6X2C	500	1/2"	6"	1.00"	2.00"	1.50"
J5/8X6X11/2A	1000	5/8"	6"	1.00"	1.50"	1.375"
J5/8X12X4C	500	5/8"	12"	1.00"	4.00"	2.75"
J3/4X10X2C	1500	3/4"	10"	2.00"	2.75"	1.75"
J3/4X12X4C	975	3/4"	12"	2.00"	4.00"	2.75"
J7/8X12X4C	1350	7/8"	12"	2.00"	4.00"	2.875"
J7/8X14X5C	1175	7/8"	14"	2.00"	5.00"	3.375"
J1X12X4C	1950	1"	12"	2.00"	4.00"	3.00"
J1X18X6C	1475	1"	18"	2.00"	6.00"	4.00"

### Common Alloy S-Hooks ± 5% on Dimensions

ID Number	Working Load Limit (Lbs.)	Rod Dia. D	Length L	Inside Bowl Dia. B	Bowl Depth A
S1/4X4X1	125	1/4"	4"	1.00"	1-1/4"
S5/16X6X1	275	5/16"	6"	1.00"	1-5/16"
S3/8X4X1	425	3/8"	4"	1.00"	1-3/8"
S1/2X8X1	775	1/2"	8"	1.00"	1-1/2"
S5/8X8X11/2	1125	5/8"	8"	1.50"	2-1/8"
S3/4X10X2	1500	3/4"	10"	2.00"	2-3/4"
S7/8X10X3	1600	7/8"	10"	3.00"	3-7/8"
S1X12X3	2300	1"	12"	3.00"	4"

# WHITELAW RIGGING & FAB.

## J-Hook and Manganal Hanger Care and Use Instructions

### J-Hooks

- Loads may disengage from hook if proper procedures are not followed
- A falling load may cause serious injury or death
- Do not apply more force than the hook's working load limit (WLL)
- Do not use a stretched or deformed hook
- Do not attempt any repairs
- Do not heat, weld, re-shape or bend
- Make sure load is centered in the bowl of the hook – never tip-load or side-load
- Inspect hook each day before being used and during use as service conditions warrant
- Remove from service immediately any hook that is nicked, worn, cracked, gouged, deformed or damaged in any way

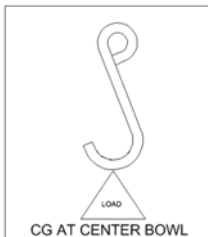

### Manganal Hangers

Special caution must be observed when using Manganal hangers. Manganal hangers do not have the same elongation characteristics as conventional alloy J-hooks. The same extreme hardness and abrasion resistance that makes Manganal hangers long lasting in blast conditions, reduces the ability of the hanger to deform under load. Always remove from service any hanger that shows deformation.

- Loads may disengage from hanger if proper procedures are not followed
- A falling load may cause serious injury or death
- Do not apply more force than the hanger's Working Load Limit. Manganal hangers are not stamped with WLL or serial number, due to extreme surface hardness
- Do not use a stretched or deformed hanger
- Do not heat, weld, re-shape or bend
- Make sure load is centered in the bowl of the hanger – never tip-load or side-load
- Inspect hanger each day before being used and during use as service conditions warrant
- Remove from service immediately any hanger that is nicked, worn, cracked, gouged, deformed or damaged in any way

# WHITELAW RIGGING & FAB.

## Design Your Own J-Hook

### DESIGN YOUR OWN "J" HOOK

Qty: \_\_\_\_\_

Working Load Limit (Required) \_\_\_\_\_

Eye Style (A, B, or C) \_\_\_\_\_

Eye Diameter (E): \_\_\_\_\_

Bowl Depth (A): \_\_\_\_\_

Bowl Diameter (B): \_\_\_\_\_

Material Dia. \_\_\_\_\_

Length (L) \_\_\_\_\_

Chamfered Ends (Yes/No) \_\_\_\_\_

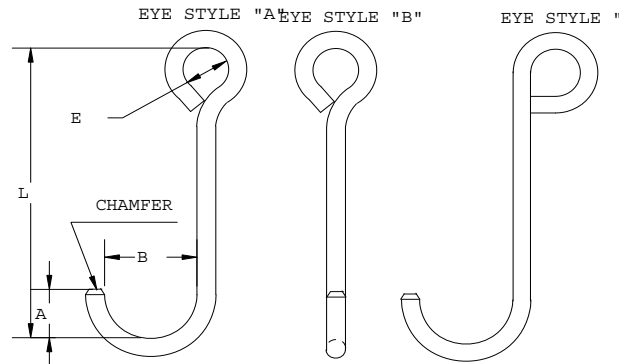

### Unusual Conditions

Max/Min Temperatures: \_\_\_\_\_

Corrosion Exposure: \_\_\_\_\_

Shock Loading: \_\_\_\_\_

Special Materials: \_\_\_\_\_

All hooks are heat treated alloy steel , proof tested and stamped with serial number and working load limit.  
Other configurations can be designed and fabricated to suit your specific lifting applications.

### DESIGN YOUR OWN "S" HOOK

Qty: \_\_\_\_\_

Working Load Limit (Required) \_\_\_\_\_

Bowl Depth (A): \_\_\_\_\_

Bowl Diameter (B): \_\_\_\_\_

Material Dia. \_\_\_\_\_

Length (L) \_\_\_\_\_

Chamfered Ends (Yes/No) \_\_\_\_\_

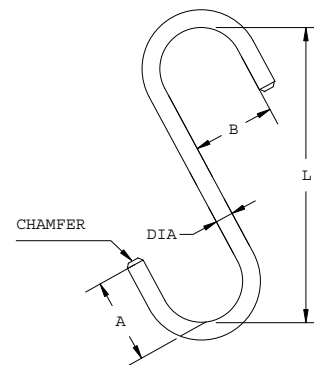

### Unusual Conditions

Max/Min Temperatures: \_\_\_\_\_

Corrosion Exposure: \_\_\_\_\_

Shock Loading: \_\_\_\_\_

Special Materials: \_\_\_\_\_



See J-hook Care and Use Instructions at the beginning of this section